

10x10 Booth

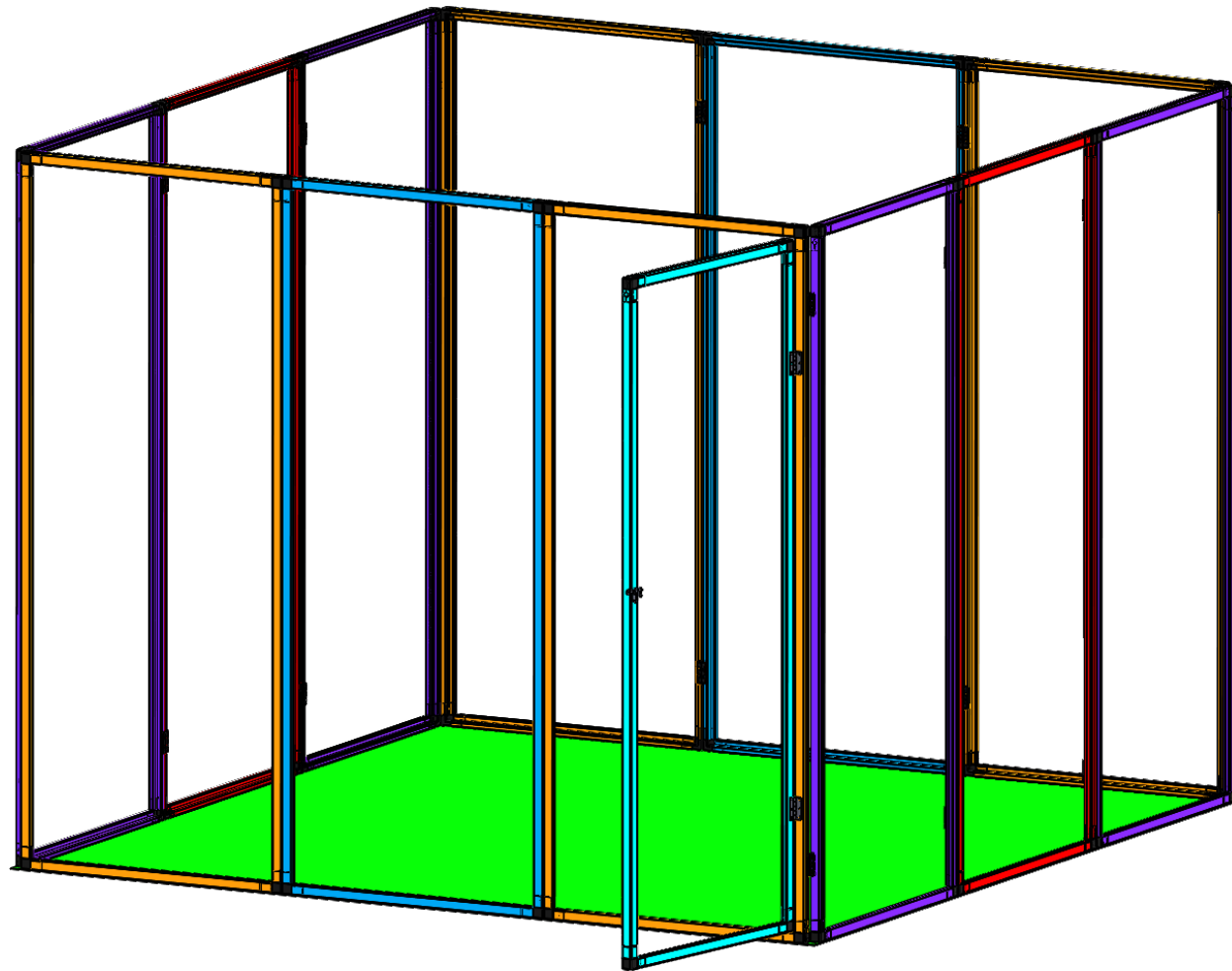

Trade Show Booth Frame

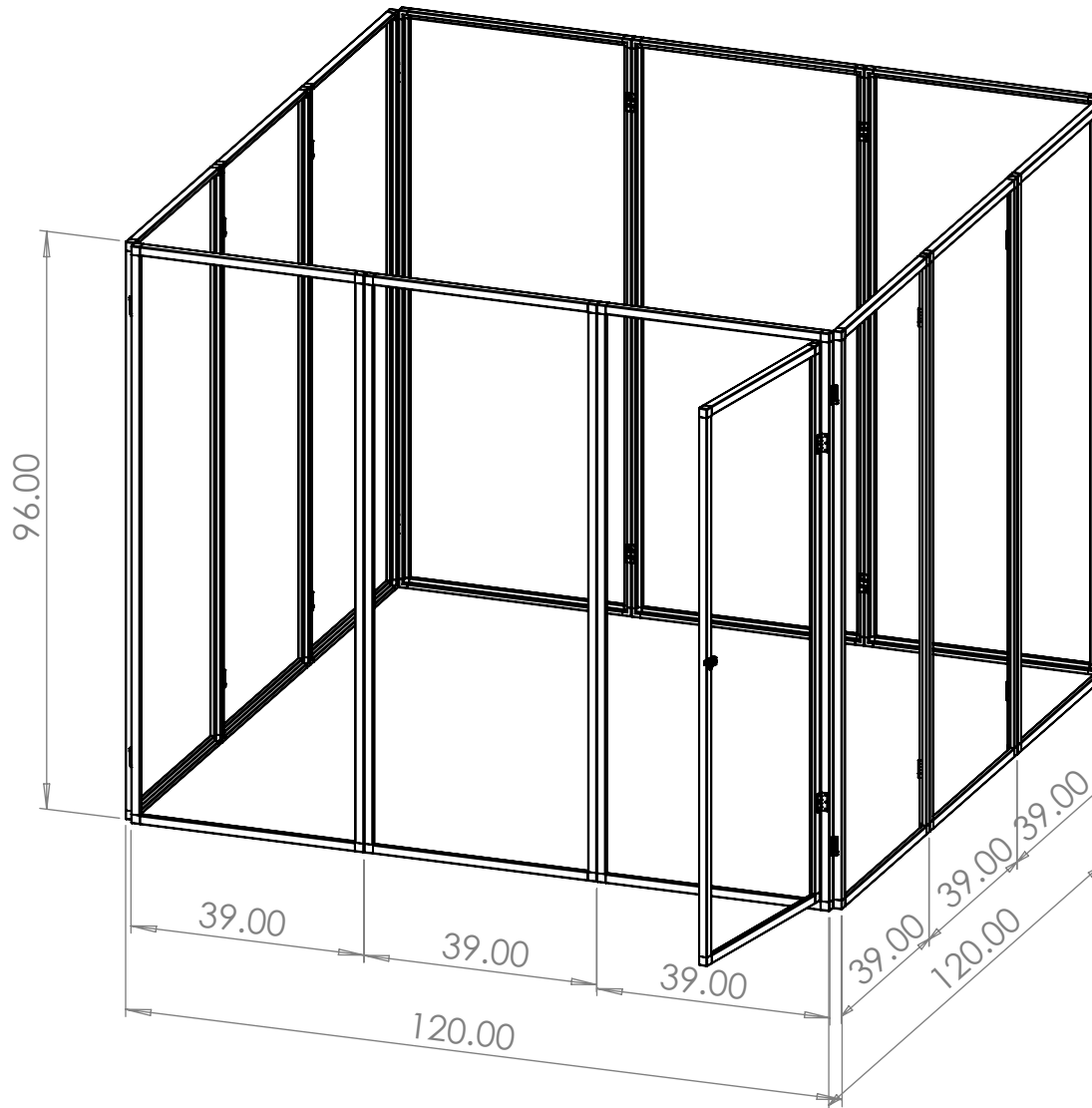

Date: 1-20-26

Description: 10 x 10 Square Trade Show Booth

Part Number:

Page: 2 Of: 9

Customer:

Drawn by:

Moxitec
ALUMINUM FRAME COMPONENTS

5

4

3

2

1

Exploded View

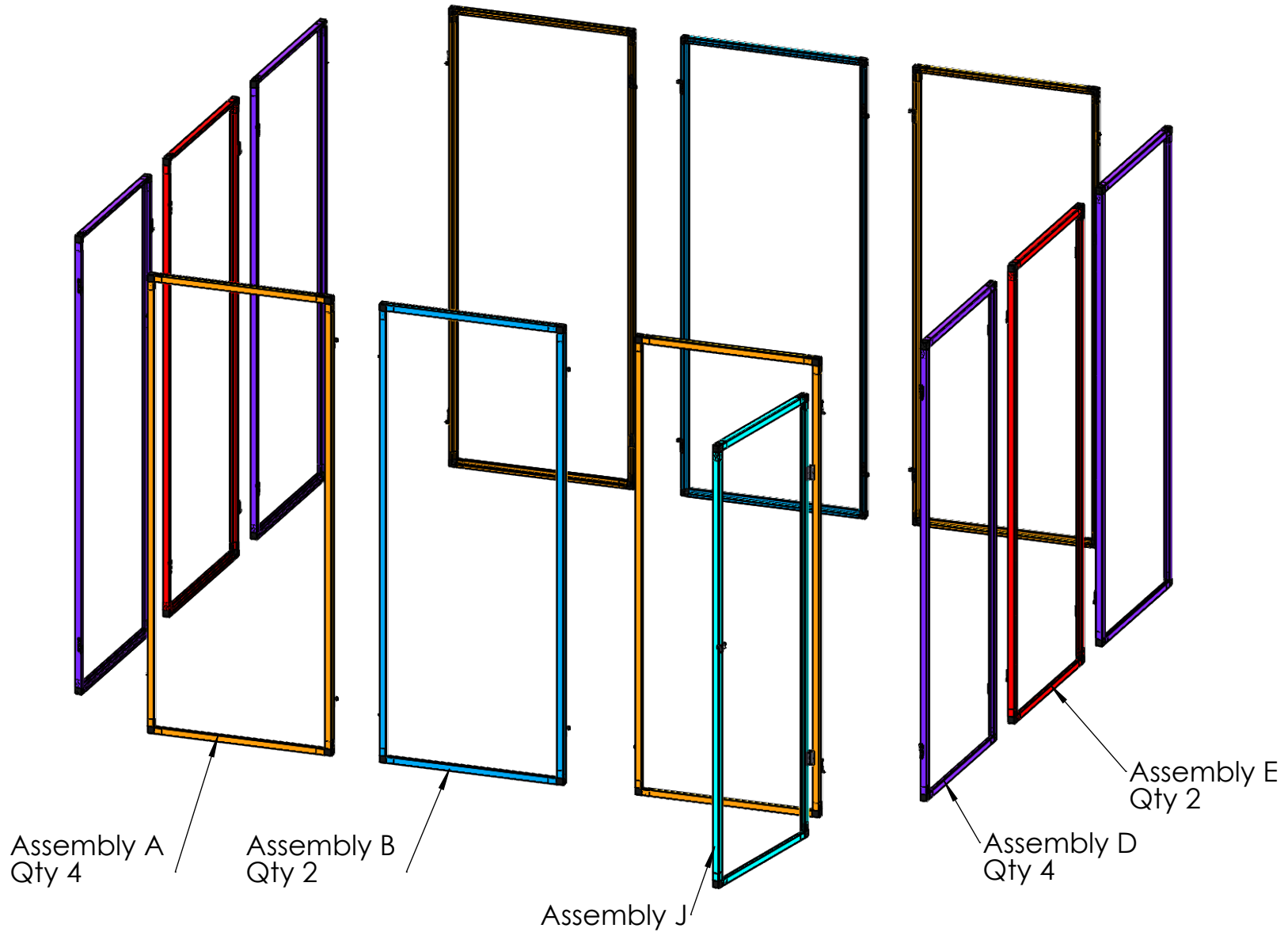

Front

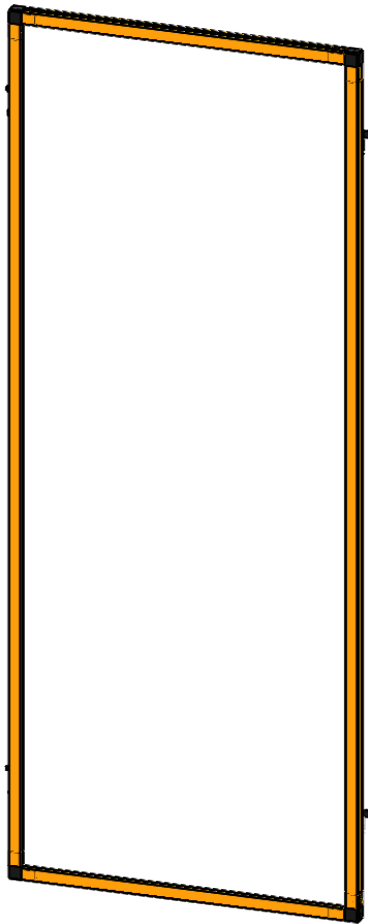

Assembly A - Qty 4

Back

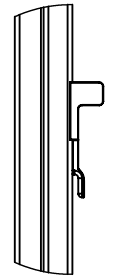
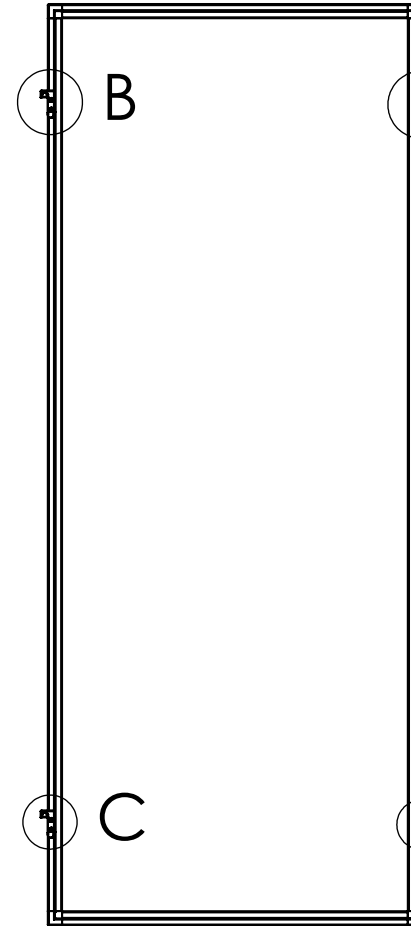

DETAIL D
SCALE 1 : 5

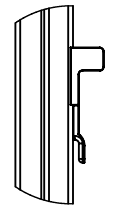

DETAIL E
SCALE 1 : 5

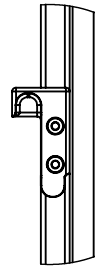

DETAIL B
SCALE 1 : 5

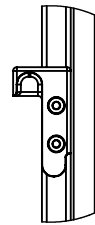

DETAIL C
SCALE 1 : 5

ITEM	QTY.	Part No.	DESCRIPTION	LENGTH (IN)	WIDTH (IN)
1	1				
2	2	TLA1-BL	L-Tube (Tight Fit - Black)	36	
3	2	TLA1-BL	L-Tube (Tight Fit - Black)	93	
4	2	HBC180	Bear Clip 180 - Straight Clip		
5	4	JL2150	2-Way 90 degree corner joint		
6	2	HBC90	Bear Clip 90 - Clip at 90 Degrees		

Assembly B - Qty 2

Front

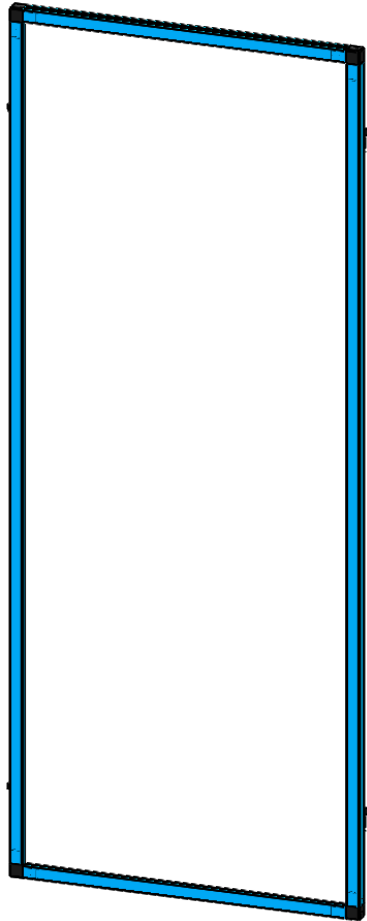

Back

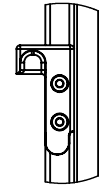
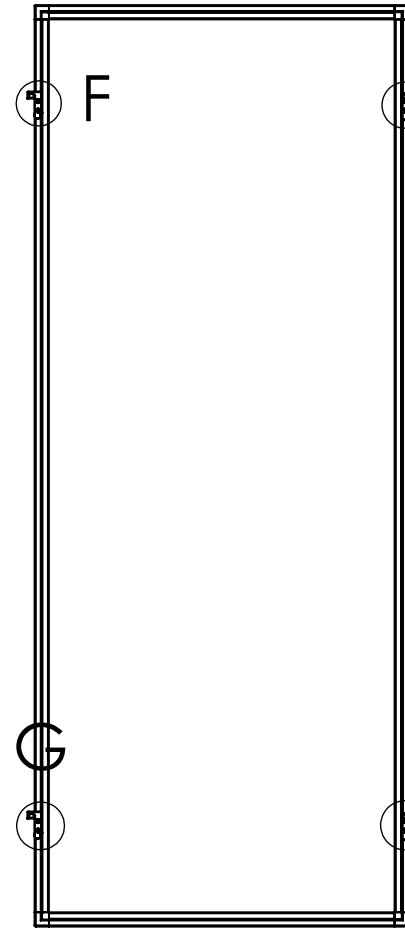

DETAIL F

SCALE 1 : 5

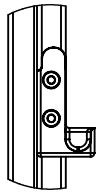

DETAIL I

SCALE 1 : 5

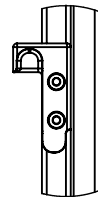

DETAIL G

SCALE 1 : 5

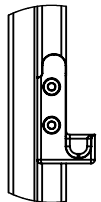

DETAIL H

SCALE 1 : 5

ITEM	QTY.	Part No.	DESCRIPTION	LENGTH (IN)	WIDTH (IN)
1	1				
2	2	TLA1-BL	L-Tube (Tight Fit - Black)	36	
3	2	TLA1-BL	L-Tube (Tight Fit - Black)	93	
4	4	HBC180	Bear Clip 180 - Straight Clip		
5	4	JL2150	2-Way 90 degree corner joint		

Date: 1-20-26

Description: 10 x 10 Square Trade Show Booth

Part Number:

Moxitec
ALUMINUM FRAME COMPONENTS

Page: 5 Of: 9

Customer:

Drawn by:

Front

Assembly D - Qty 4

Back

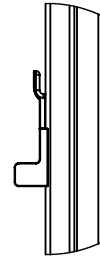
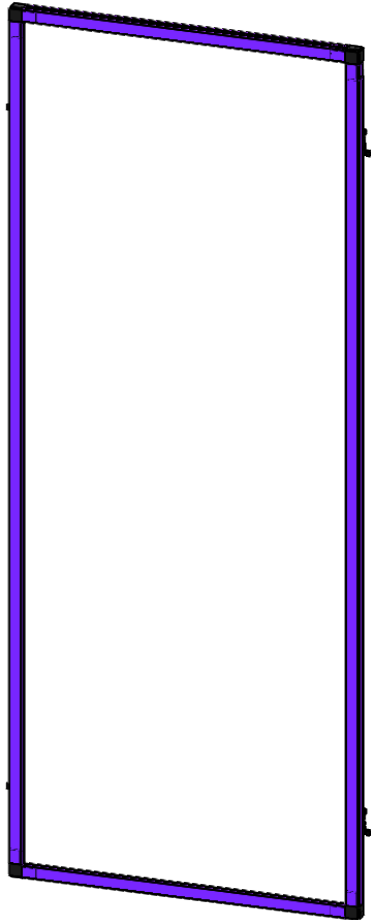

DETAIL M

SCALE 1 : 5

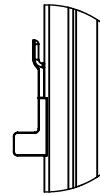

DETAIL L

SCALE 1 : 5

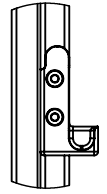
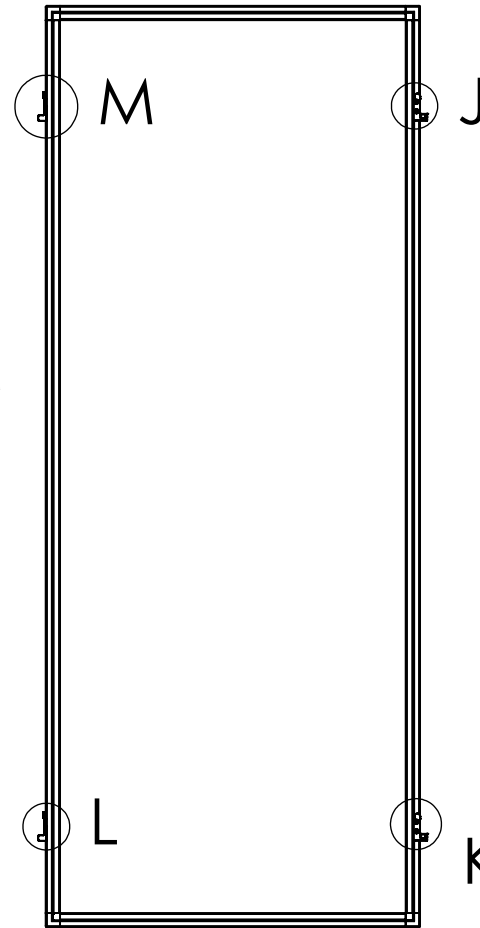

DETAIL J

SCALE 1 : 5

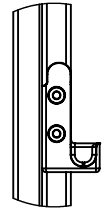

DETAIL K

SCALE 1 : 5

ITEM	QTY.	Part No.	DESCRIPTION	LENGTH (IN)	WIDTH (IN)
1	1				
2	2	TLA1-BL	L-Tube (Tight Fit - Black)	36	
3	2	TLA1-BL	L-Tube (Tight Fit - Black)	93	
4	2	HBC180	Bear Clip 180 - Straight Clip		
5	4	JL2150	2-Way 90 degree corner joint		
6	2	HBC90	Bear Clip 90 - Clip at 90 Degrees		

Date: 1-20-26

Description: 10 x 10 Square Trade Show Booth

Part Number:

Moxitec
ALUMINUM FRAME COMPONENTS

Page: 6 Of: 9

Customer:

Drawn by:

Assembly E - Qty 2

Front

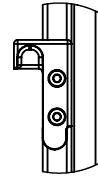
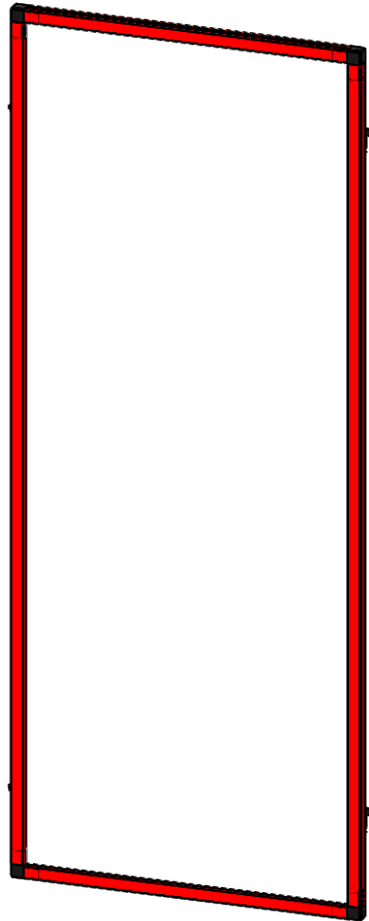

N

DETAIL N

SCALE 1 : 5

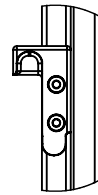

DETAIL O

SCALE 1 : 5

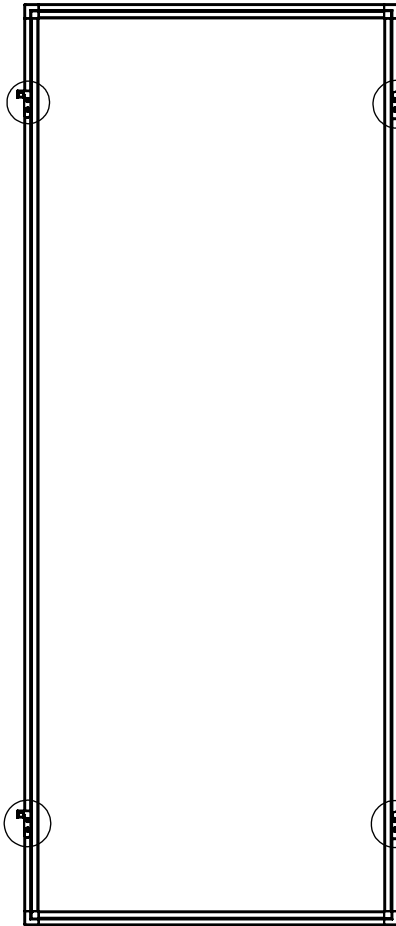

Q

DETAIL Q

SCALE 1 : 5

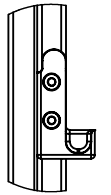

DETAIL R

SCALE 1 : 5

ITEM	QTY.	Part No.	DESCRIPTION	LENGTH (IN)	WIDTH (IN)
1	1				
2	2	TLA1-BL	L-Tube (Tight Fit - Black)	36	
3	2	TLA1-BL	L-Tube (Tight Fit - Black)	93	
4	4	HBC180	Bear Clip 180 - Straight Clip		
5	4	JL2150	2-Way 90 degree corner joint		

Date: 1-20-26

Description: 10 x 10 Square Trade Show Booth

Part Number:

Moxitec
ALUMINUM FRAME COMPONENTS

Page: 7 Of: 9

Customer:

Drawn by:

Assembly J



DETAIL S
SCALE 1 : 5

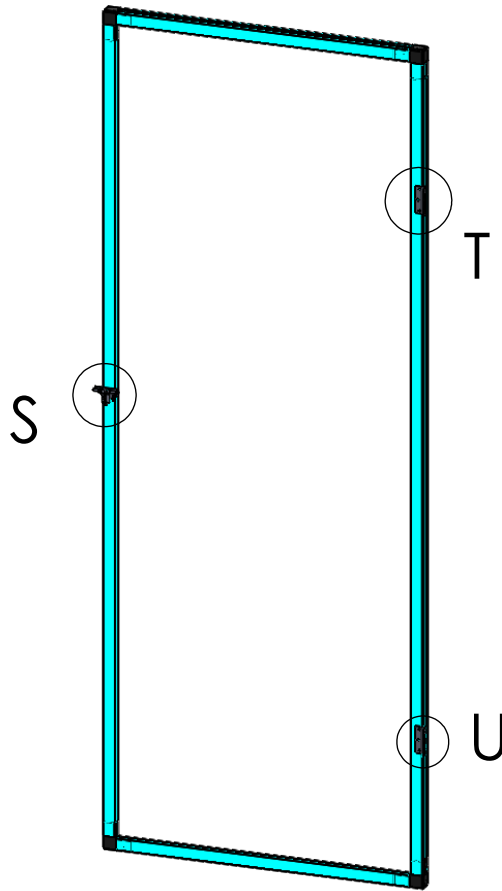

DETAIL T
SCALE 1 : 5



DETAIL U
SCALE 1 : 5

ITEM	QTY.	Part No.	DESCRIPTION	LENGTH (IN)	WIDTH (IN)
1	4	JL2150	2-Way 90 degree corner joint		
2	1				
3	2	TLA1-BL	L-Tube (Tight Fit - Black)	32.625	
4	2	TLA1-BL	L-Tube (Tight Fit - Black)	89.625	
5	2	Hinge A			
6	2	Hinge B			
7	1	LCH150	Stainless Steel Latch - LCH150		

Pan Head Screw
PPHS10-625

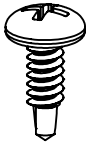

2 Way - JL2150

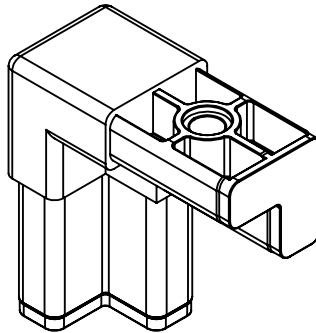

Bear Clip 180 Assembly

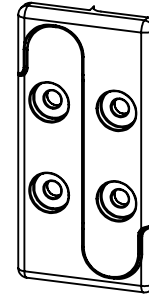

Bear Clip 90 Assembly

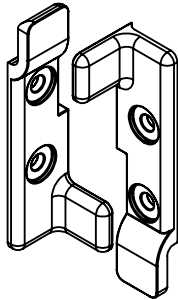

Stainless Latch - LCH150

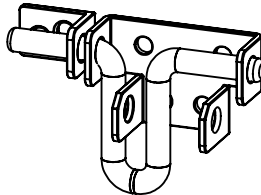

Hinge - HNG2030-ZC

